

# Downloading and installing custom firmware versions

1. Connect the app to an ART7 AsteraBox. BlueMode all the lights you need to update and press “Pair with Lights” as usual. Wait till all lights are paired.
2. Make sure your device has an internet connection. Either via Wi-Fi or cellular network.
3. Go to the App Settings. Make sure “TalkBack+” and “Keep Screen On” is toggled ON, then press “Lights Background Update
4. Make sure Auto Update is switched OFF, then press and hold the Update button in the top right-hand corner for a few seconds until you get a pop-up.
5. Once the pop-up appears, type in the custom download code. In this instance: **51267** and press OK. The custom firmware will then download to the app. Custom firmware files are Fixture specific.

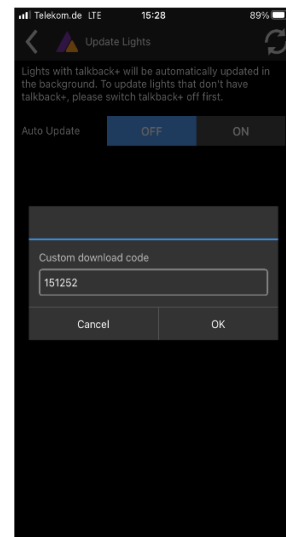

6. You will see the lights appear in the list with several options for updating firmware. Select the Custom Firmware version you want to update to.
7. Click “OK” on the Custom Firmware warning, then “Yes” to start the transfer of the custom Firmware version

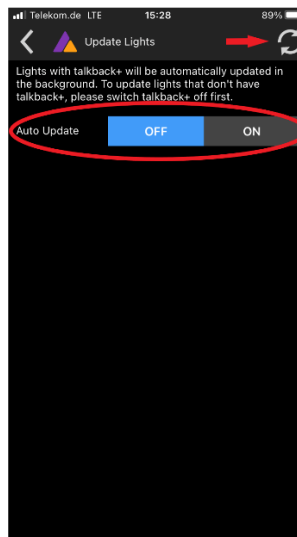
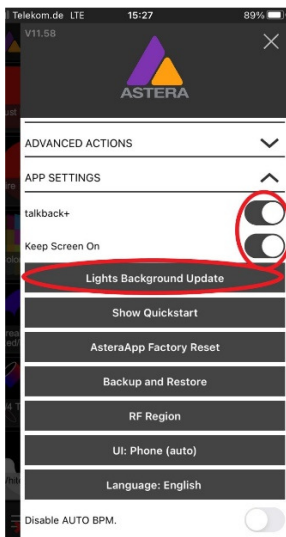
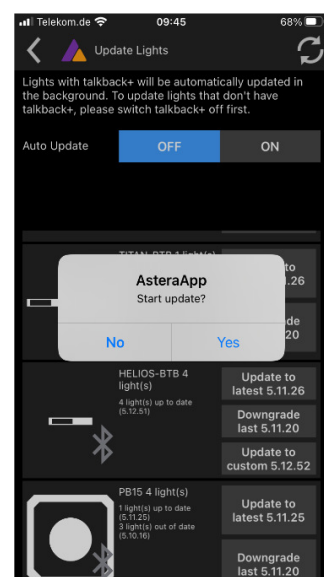
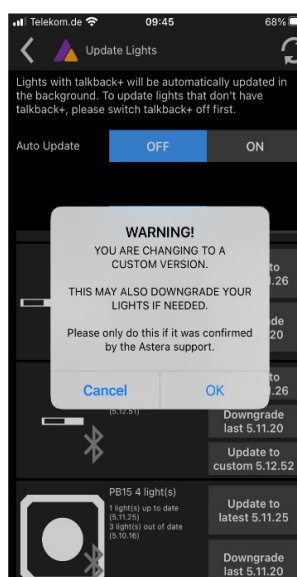
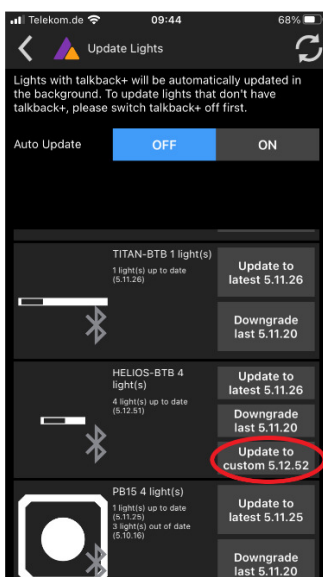

8. You will see a progress bar showing the transfer of the file to the lights. Once the transfer is completed a new button will appear, saying “Reboot and Install Update” Press this button and after a few seconds, the lights will switch off, and when they start up again, they will automatically install the new firmware.

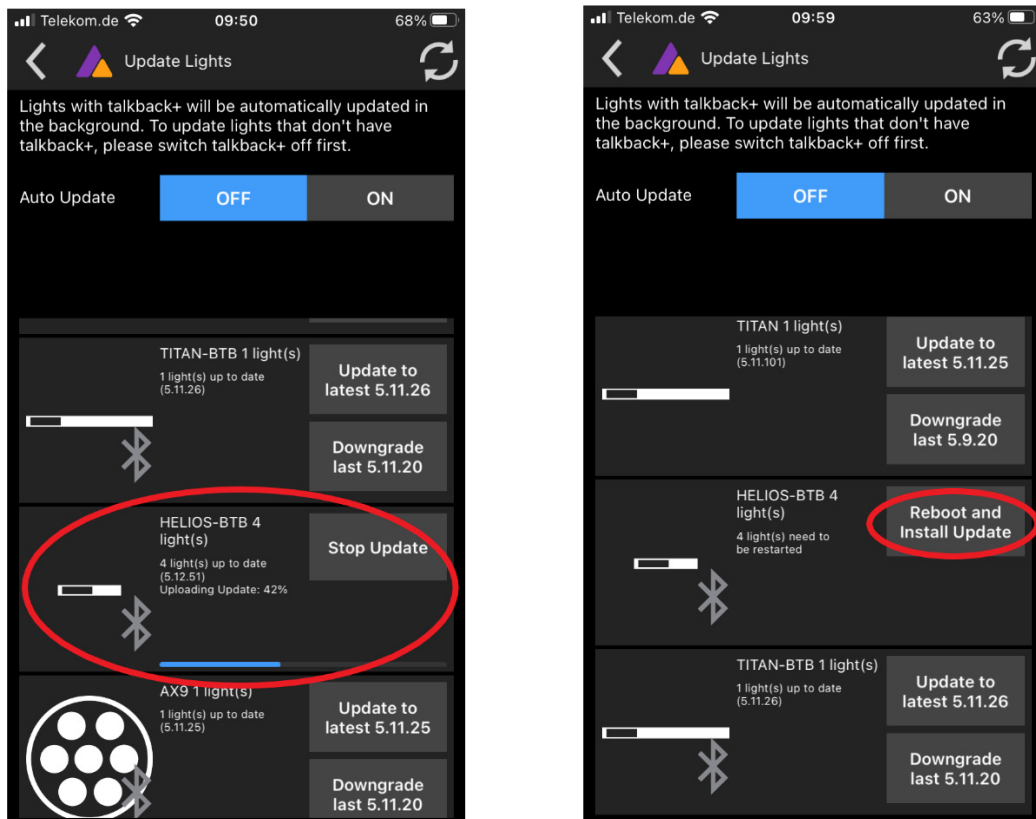

In case one or more lights fail to install the update, go back to step 6. At this point you can power off the lights that have taken the update, but it is not necessary to do so. Running the Custom update again, will not affect the lights that have already been updated.